

16 Airfield Way, Corby, NN17 3LX

Sell My Home are pleased to present to the market this well presented and ready to move into three bedroom semi detached house in Weldon. The property could be ideal for those looking for a family home or those looking for investment purposes.

As you enter you will find the hallway with downstairs W/C, stairs to the upper floor and doorway leading to the lounge and kitchen.

The lounge is generously sized and leads onto the sizeable fitted kitchen, which also includes plenty of space for a dining area and patio doors leading out into the rear garden.

Heading upstairs you will find a main bedroom, complete with en suite, a double bedroom, a single bedroom and a three piece family bathroom.

Externally the property offers a driveway with parking for two vehicles and a landscaped rear garden.

Price Guide £225,000

16 Airfield Way

Weldon, Corby, NN17 3LX



- THREE BEDROOM SEMI DETACHED HOUSE
- DRIVEWAY FOR TWO VEHICLES
- REAR GARDEN
- GOOD TRANSPORT LINKS
- VIEWING ADVISED



Directions



Floor Plan

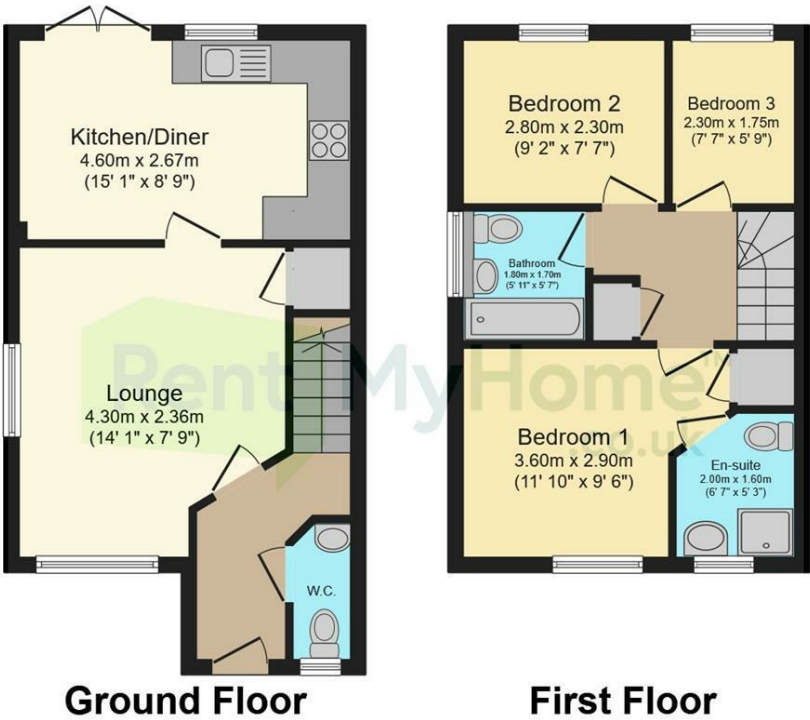

Total floor area 69.0 m² (743 sq.ft.) approx

This floor plan is for illustrative purposes only. It is not drawn to scale. Any measurements, floor areas (including any total floor area), openings and orientation are approximate. No details are guaranteed, they cannot be relied upon for any purpose and they do not form part of any agreement. No liability is taken for any error, omission or misstatement. A party must rely upon its own inspection(s). Powered by www.focalagent.com

These particulars, whilst believed to be accurate are set out as a general outline only for guidance and do not constitute any part of an offer or contract. Intending purchasers should not rely on them as statements of representation of fact, but must satisfy themselves by inspection or otherwise as to their accuracy. No person in this firms employment has the authority to make or give any representation or warranty in respect of the property.

